

LEGEND

- EXISTING CONTOURS
- NEW, OR PROPOSED CONTOURS
- PROPOSED CONTOURS
- DIRECTION OF SURFACE DRAINAGE FLOW
- EXISTING FINISH FLOOR
- NEW, OR PROPOSED FINISH FLOOR

GENERAL NOTES

1. PLANS PREPARED AT THE REQUEST OF: PAUL MOSGORN
2. SURVEY BY PAUL MOSGORN, SEP. 2014
3. ELEVATIONS BASED ON ASSUMED DATUM.
4. THIS IS NOT A BOUNDARY SURVEY.

EARTHWORK NOTES

- OUT VOLUME: 150 CY
- FILL VOLUME: 0 CY
- NET VOLUME: ROAD: 150 CY CUT/FILL
- NET VOLUMES: ROAD AND HOUSE: 200 CY
- LENGTH OF PROPOSED PAVED DRIVE = 290.5 FT
- AREA OF PAVED SURFACE IN R.O.W. = 5231 SF
- VOLUME OF ASPHALT ROAD BASE (AB) = 97 CY

DRAINAGE NOTES

DRAINAGE DIRECTIONS AS SHOWN BY DRAINAGE ARROWS ON PLANS POSITIVE DRAINAGE, OR OUTSLOPING OF THE ROAD, WITH GROWN ALONG CENTERLINE, SHALL BE MAINTAINED THROUGHOUT.
SHOULDERS OF ROAD SHALL INCLUDE SWALES, WHERE SHOWN.

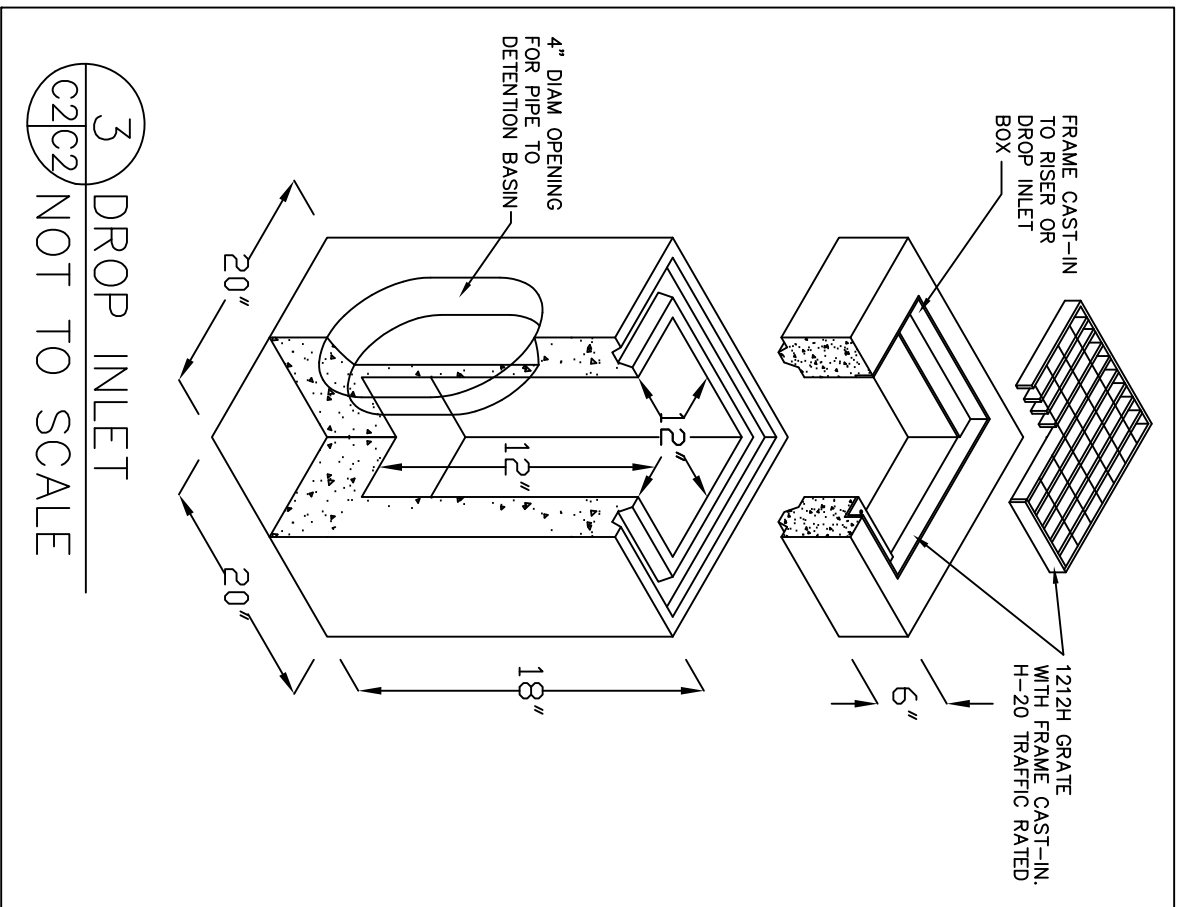

3 DROP INLET
NOT TO SCALE

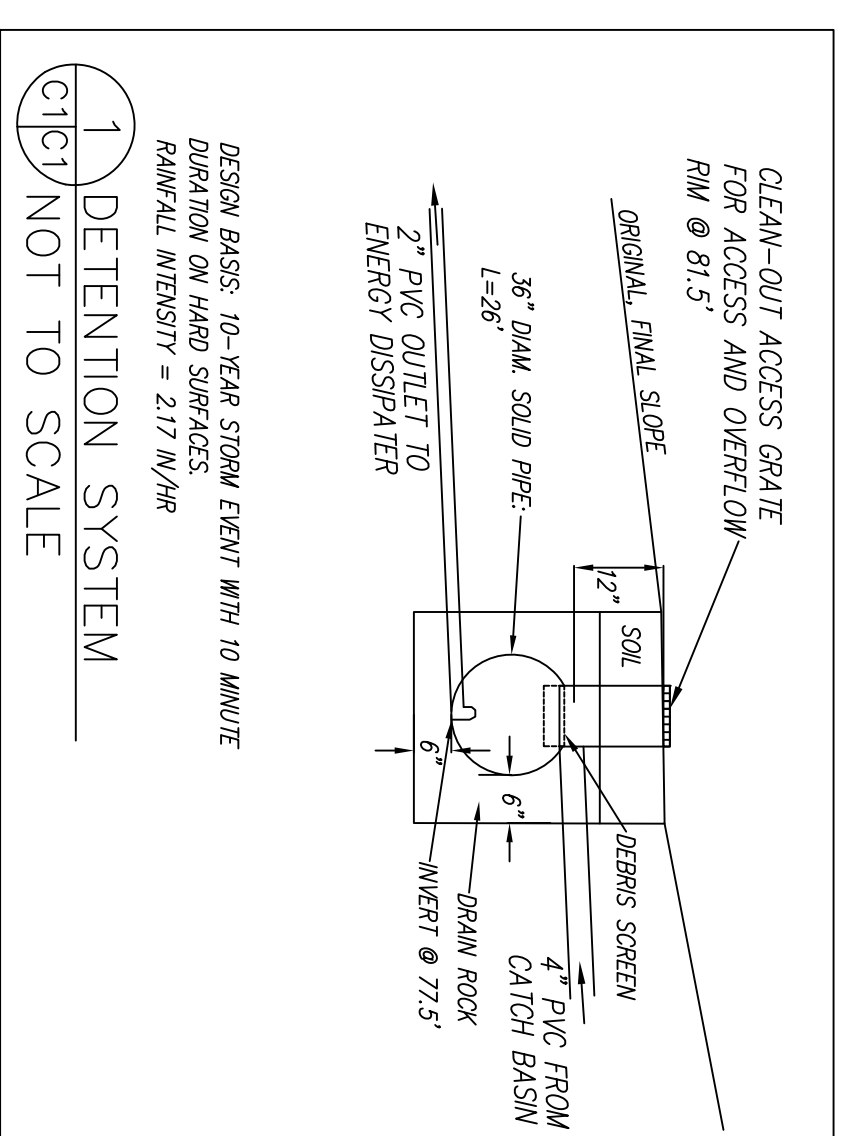

1 DETENTION SYSTEM
NOT TO SCALE

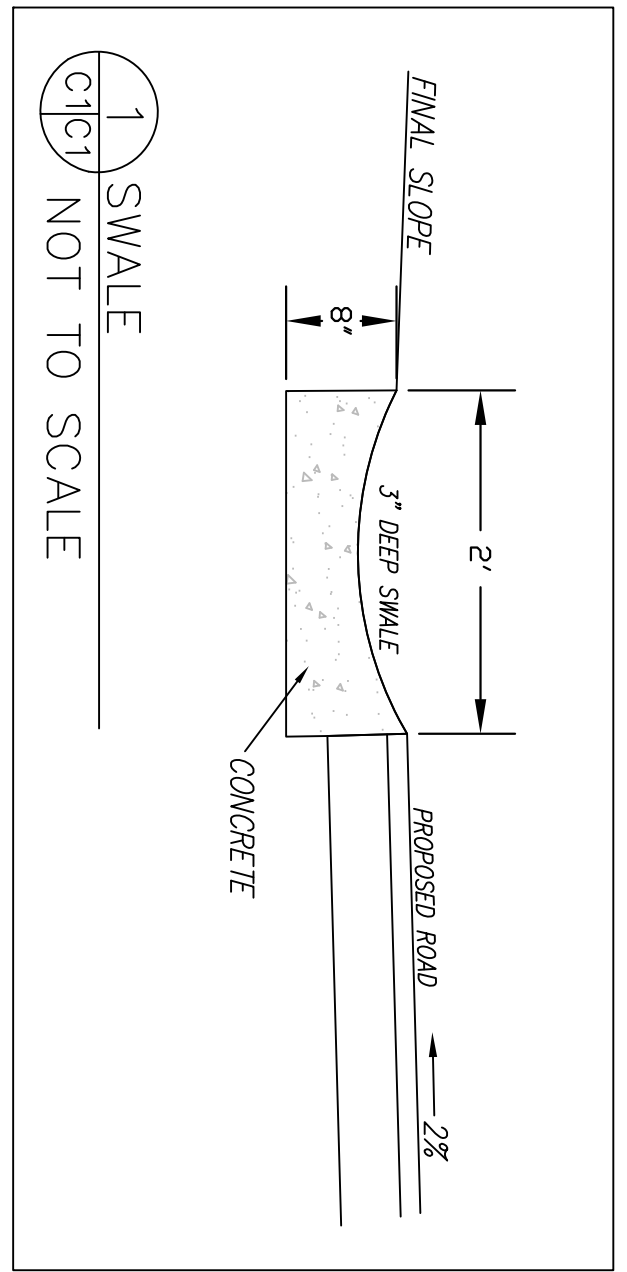

1 SWALE
NOT TO SCALE

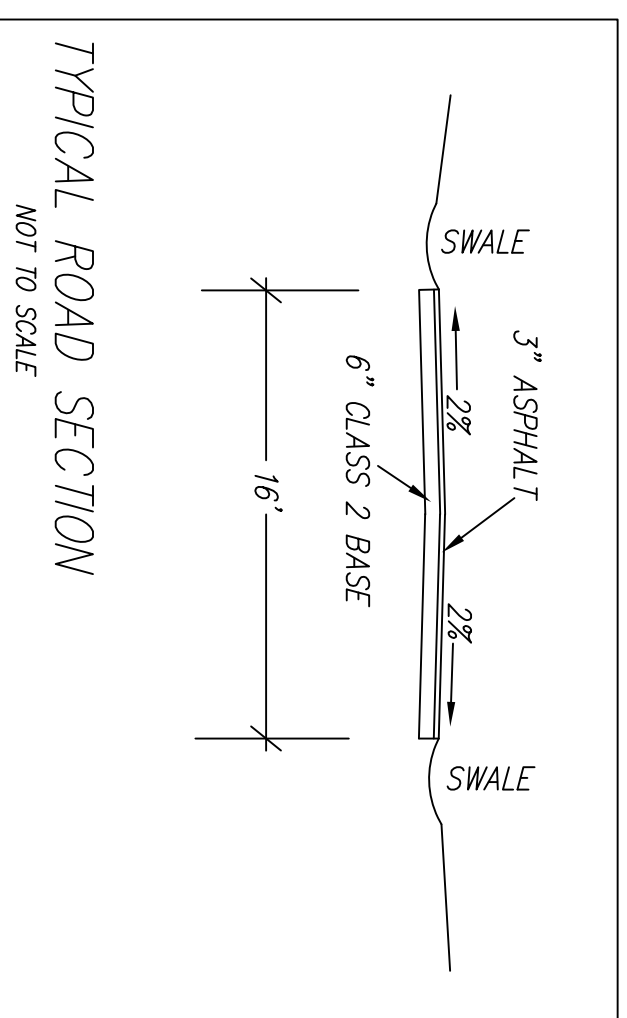

TYPICAL ROAD SECTION
NOT TO SCALE

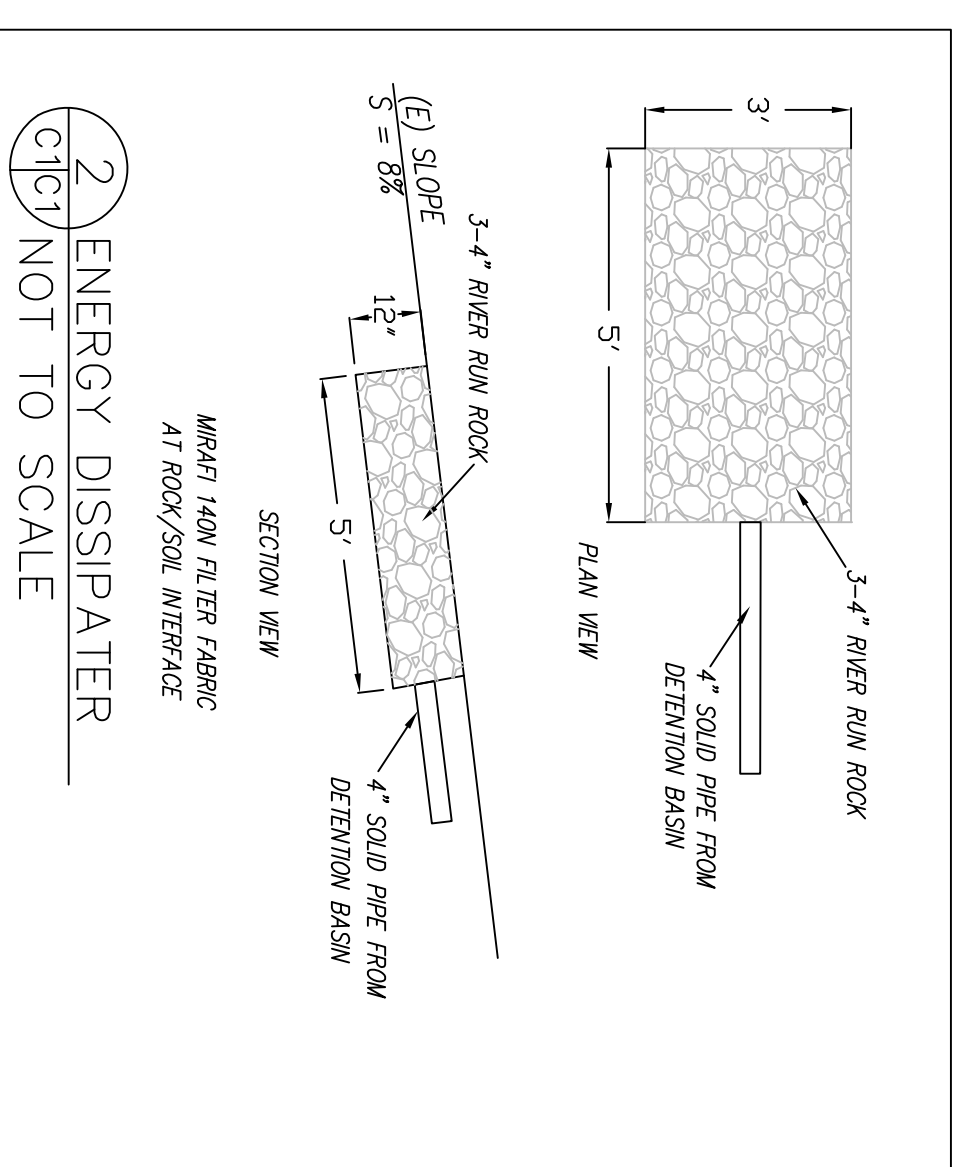

2 ENERGY DISSIPATER
NOT TO SCALE

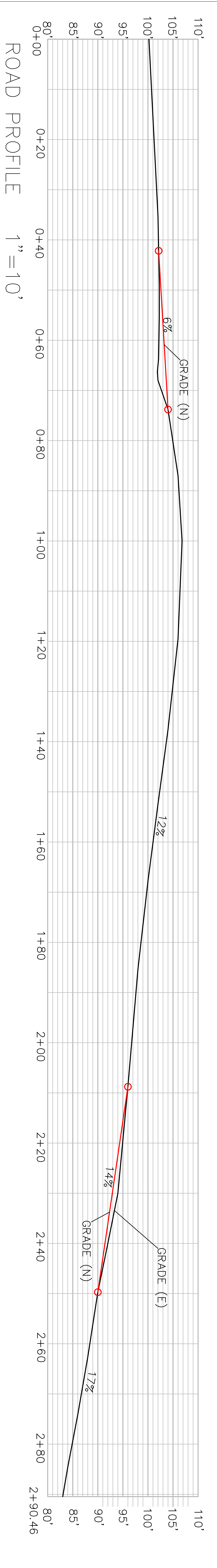

	GRADING AND DRAINAGE PLAN - ROAD		DATE: 8-24-17	
	1900 EAST AVE. MONTARA, CALIFORNIA APN: 037-015-019		DRAWN BY: CMK	
	Sigma Prime Geosciences, Inc. 332 PRINCETON AVENUE HALF MOON BAY, CA 94019 (650) 728-3590 FAX: 728-3593		CHECKED BY: AZG	
			REV. DATE: REV. DATE:	